



Technical Data



Product name: AKE SERIES

Affiliate classification: Slewing Drive
Structural parameters:

The protection grade of AKE series can reach IP55, suitable for outdoor use, with effective dust proof and waterproof. Mainly used for photovoltaic single and double axis tracking system, concentrating photovoltaic tracking system, tower heliostat, dish Stirling power, trough poly thermal power heating and the application rang of S series .

AXIAL LOAD & TILTING MOMENT

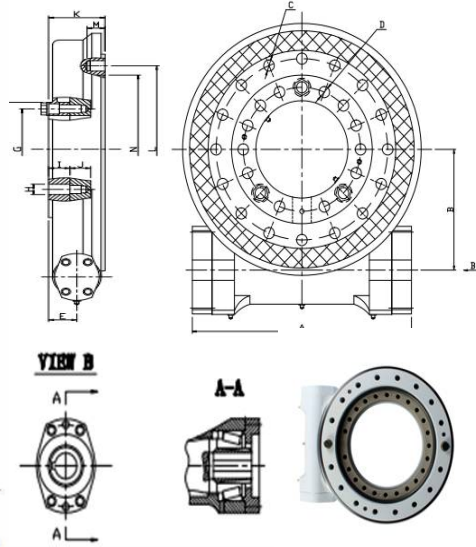
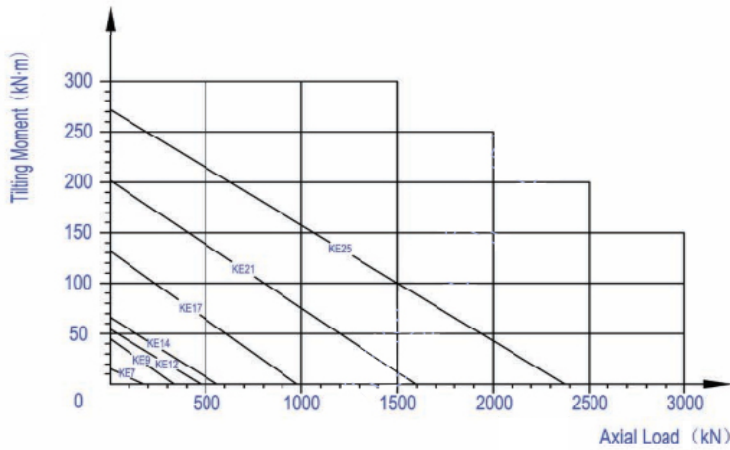

Product description:

	Slewing Drive Ratio	Efficiency	Nom.	MAX.	Holding	Tilting	Static	Static	Dynamic	Dynamic	Self-Locking	Torsion	Bending
			Output	Output	Torque	Moment	Radial	Axial	Radial	Axial		Stiffness	Stiffness
			Torque	Torque		Torque	Rating	Rating	Rating	Rating			
			N.m	N.m	N.m	N.m	KN	KN	KN	KN		Nm/mRad	Nm/mRad
AKE3	62	43%	650	1349	3000	1000	16.1	29.4	8.4	9.6	YES	333	159
AKE5	62	43%	760	1536	4700	3750	27.1	67.6	14	16.5		780	1900
AKE7	73	43%	2010	4020	7034	13556	53.3	133.2	27.9	31.9		780	1900
AKE9	61	43%	4480	8960	39083	45000	135	337.4	70.9	81		1125	2378
AKE12	78	43%	5795	11590	49975	54240	190.3	475.1	99.8	114		2000	4191
AKE14	85	43%	6497	12994	54455	67800	222	555	116.6	133.2		3400	9224
AKE17	102	43%	9360	18720	65633	135600	390.7	976.8	205.1	234.4		6400	12000
AKE21	125	43%	16010	32020	81000	203400	639.4	1598.5	335.7	383.6		7500	82000
AKE25	150	43%	24011	42995	89100	271164	944	2360	472	590		8400	82000

AKE SERIES

Mounting Dimension Sheet

UNIT:mm

TYPE	A	B	C	D	E	F	G	H	I	J	K	L	M	N
AKE3	154	80	6*M10 EQS	3*M10 EQS	46.5	Φ120	Φ100			16	109	Φ100	20	
AKE5	170.5	93.8	6*M10 EQS	8*M10 EQS	36	Φ100	Φ70	Φ11	21	20	74	Φ130	20	Φ103.5
AKE7	234	132.7	8*M12 EQS	10*M12 EQS	44.5	Φ145	Φ120.7	Φ14	20	18	90.5	Φ203.2	18	Φ163
AKE9	321.7	174.1	16*M16 EQS	15*M16 Based on 16 EQS	57.1	Φ204	Φ175	Φ18	38	44	113.1	Φ270	32	Φ222.5
AKE12	341.5	220	18*M16 EQS	19*M16 Based on 20 EQS	61.4	Φ289	Φ259	Φ18	39	44	118.4	Φ358	32	Φ310.3
AKE14	347.5	237.6	18*M16 EQS	23*M16 Based on 24 EQS	59	Φ325	Φ295	Φ18	33	43	117	Φ390	32	Φ342.5
AKE17	405	280.4	20*M16 EQS	20*M16 EQS	57	Φ406	Φ365.1	Φ18	34	48	120	Φ480	32	Φ425
AKE21	469	345	29*M20 EQS	15*M16 Based on 30 EQS	60.5	Φ534	Φ466.7	Φ22	32	50	135	Φ584	40	Φ525.4
AKE25	401.8	401.8	36*M20 EQS	35*M20 Based on 36 EQS	76.2	Φ628	Φ565	Φ22	47	40	130	Φ675	65	Φ620



Technical Data



Product name:AKE-2 SERIES

Affiliate classification : Slewing Drive

Structural parameters:

AKE-2 series has two worm at the same time, the output torque can reach more than 1.5 times then the single worm, while the holding torque greatly increased, suitable for the equipment which has large torque but the installation size is limited.

AXIAL LOAD & TILTING MOMENT

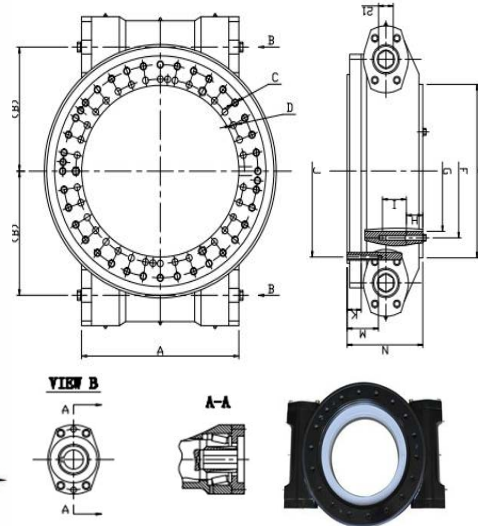
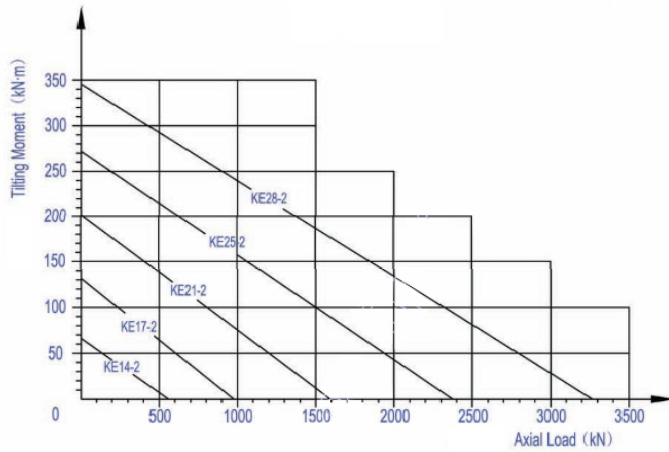

Product description:

	Slewing Drive Ratio	Efficiency	Nom.	MAX.	Holding	Tilting	Static	Static	Dynamic	Dynamic	Self-Locking	Torsion	Bending
			Output	Output	Torque	Moment	Radial	Axial	Radial	Axial		Stiffness	Stiffness
			Torque	Torque		Torque	Rating	Rating	Rating	Rating			
			N.m	N.m	N.m	N.m	KN	KN	KN	KN			Nm/mRad
AKE14-2	85	43%	9746	19492	81682	67800	222	555	116.6	133.2	YES	6800	9224
AKE17-2	102	43%	14040	28080	98449	135600	390.7	976.8	205.1	234.4		12800	12000
AKE21-2	125	43%	24015	32020	121500	203400	639.4	1598.5	335.7	383.6		15000	82000
AKE25-2	150	43%	36016	54024	133650	271164	944	2360	472	590		16400	82000

AKE-2 SERIES

Mounting Dimension Sheet

UNIT:mm

TYPE	A	B	C	D	E	F	G	H	I	J	K	L	M
AKE14-2	348	237.6	18*M16 EQS	23*M16 Based on 24 EQS	Φ325	Φ295.0	Φ265	33	43	Φ390.0	34	30	117
AKE17-2	405	280.4	20*M16 EQS	20*M16 EQS	Φ406	Φ365.1	Φ324	34	32	Φ479.4	30	32	120
AKE21-2	469	345	24*M20 EQS	29*M20 Based on 30 EQS	Φ534	Φ466.7	Φ432	32	40	Φ584.2		40	135
AKE25-2	470	401.8	36*M20 EQS	35*M20 Based on 36 EQS	Φ628	Φ565.0	Φ512	47	40	Φ675.0		40	165
AKE28-2	570	482.2	40*M16 EQS	39*M16 Based on 40 EQS	Φ	Φ650.0	Φ600	53	48	Φ810.0	40	48	173



Technical Data



Product name: AKDE SERIES

Affiliate classification: Slewing Drive

Structural parameters:

AKDE series are dual axis rotary devices, mainly used in biaxial tracking system such as photovoltaic and concentrating photovoltaic, tower heliostat, disc type power, etc.

AXIAL LOAD & TILTING MOMENT

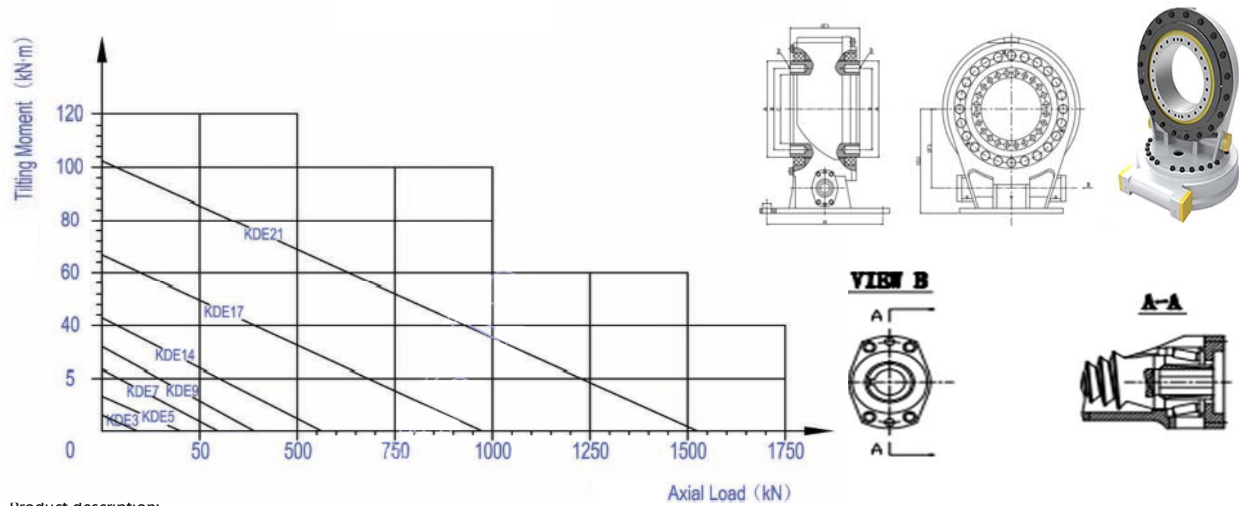

Product description:

	Slewing Drive Ratio	Efficiency	Nom.	MAX.	Holding	Tilting	Static	Static	Dynamic	Dynamic	Self-	Torsion	Bending
			Output	Output	Torque	Moment	Radial	Axial	Radial	Axial	Locking	Stiffness	Stiffness
			Torque	Torque		Torque	Rating	Rating	Rating	Rating			
			N.m	N.m	N.m	N.m	KN	KN	KN	KN		Nm/mRad	Nm/mRad
AKDE3	62	43%	599	899	2100	500	8.3	14.7	4.2	4.8	YES	222	106
AKDE5	61	43%	1350	2700	5500	6000	13.6	34	7	8.2		512	475
AKDE7	73	43%	2010	4020	10062	9489	53.3	133.2	27.9	31.9		780	1900
AKDE9	61	43%	4480	8960	39083	31500	134.9	337.4	70.9	81		1125	2378
AKDE14	85	43%	6497	12994	54455	47460	222	555	116.6	133.2		3400	9224
AKDE17	102	43%	9360	18720	65633	94992	390.7	976.8	205.1	234.4		6400	12000
AKDE21	125	43%	16010	32020	81000	152380	639.4	1598.5	335.7	383.6		7500	82000

AKDE SERIES

Mounting Dimension Sheet

UNIT:mm

TYPE	A	B	C	D	E	F	G	H	I
AKDE3	Φ85	Φ70	Φ50	6*M8 DP.16 EQS	93	80	167	Φ70.0	6*M8 DP.16 EQS
AKDE5	Φ95	Φ72	Φ54	6*M8 DP.16 EQS	144	114.2	240	Φ164	8*M12 DP.18 EQS
AKDE7	Φ140	Φ118	Φ40	8*M12 DP.24 EQS	140	133	204	Φ203.2	8*M12 DP.18 EQS
AKDE9	Φ180	Φ115	Φ30	6*M8 DP.16 EQS	278	174	414	Φ270.0	16*M16 DP.30 EQS
AKDE14	Φ180	Φ130	Φ30	6*M8 DP.16 EQS	280	238	350	Φ295.0	16*M16 DP.30 EQS
AKDE17	Φ420	Φ390	Φ360	6*M8 DP.16 EQS	220	280	484	Φ479.4	16*M16 DP.30 EQS
AKDE21	Φ470	Φ435	Φ400	6*M8 DP.16 EQS	254	345	598	Φ584.2	24*M20 DP.50 EQS



Technical Data



Product name: AS SERIES

Affiliate classification: Slewing Drive

Structural parameters:

AS series are widely used in engineering machinery industry, such as aerial vehicles, grab, truck cranes, drilling machine, agricultural machinery, etc.

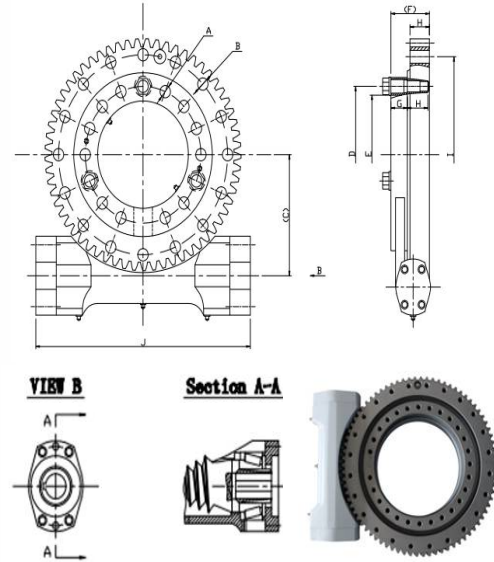
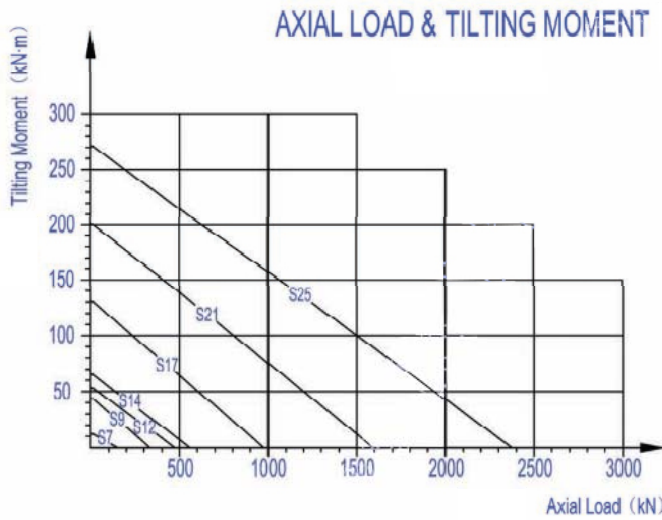

Product description:

	Slewing	Efficiency	Nom.	MAX.	Holding	Tilting	Static	Static	Dynamic	Dynamic	Self-Locking	Torsion	Bending
	Drive		Output	Output	Torque	Moment	Radial	Axial	Radial	Axial		Stiffness	Stiffness
	Ratio		Torque	Torque		Torque	Rating	Rating	Rating	Rating			
			N.m	N.m	N.m	N.m	KN	KN	KN	KN			Nm/mRad
AS7	73	43%	2010	4020	7034	13556	53.3	133.2	27.9	31.9	YES	780	1900
AS9	61	43%	4480	8960	39083	45000	135	337.4	70.9	81		1125	2378
AS12	78	43%	5795	11590	49975	54240	190.3	475.1	99.8	114		2000	4191
AS14	85	43%	6497	12994	54455	67800	222	555	116.6	133.2		3400	9224
AS17	102	43%	9360	18720	65633	135600	390.7	976.8	205.1	234.4		6400	12000
AS21	125	43%	16010	32020	81000	203400	639.4	1598.5	335.7	383.6		7500	82000
AS25	150	43%	24011	42995	89100	271164	944	2360	472	590		8400	82000

AS SERIES

Mounting Dimension Sheet

UNIT:mm

TYPE	A	B	C	D	E	F	G	H	I	J
AS7	10*M12 EQS	8*M12 EQS	132.7	Φ120.6	Φ98	63	20	18	Φ203.2	183
AS9	15*M16 Based on 16 EQS	16*M16 EQS	174.1	Φ175.0	Φ146	89	39	44	Φ270.0	233
AS12	19*M16 Based on 20 EQS	18*M16 EQS	220	Φ259.0	Φ229	89	39	44	Φ358.0	332
AS14	23*M16 Based on 24 EQS	18*M16 EQS	237.6	Φ295.0	Φ265	89	39	43	Φ390.0	338
AS17	20*M16 EQS	20*M16 EQS	280.4	Φ365.1	Φ324	103	47	48	Φ479.4	385
AS21	35*M20 Based on 36 EQS	36*M20 EQS	345	Φ466.7	Φ435	137	42	50	Φ584.2	469
AS25	35*M20 Based on 36 EQS	36*M20 EQS	401.8	Φ565.0	Φ512	130	47	40	Φ675.0	469



Technical Data



Product name: AVE SERIES

Affiliate classification: Slewing Drive

Structural parameters:

AVE series of vertical rotary device, is currently mainly used in flat single axis photovoltaic tracking system, is the most cost-effective and investment returns in PV tracking system.

AXIAL LOAD & TILTING MOMENT

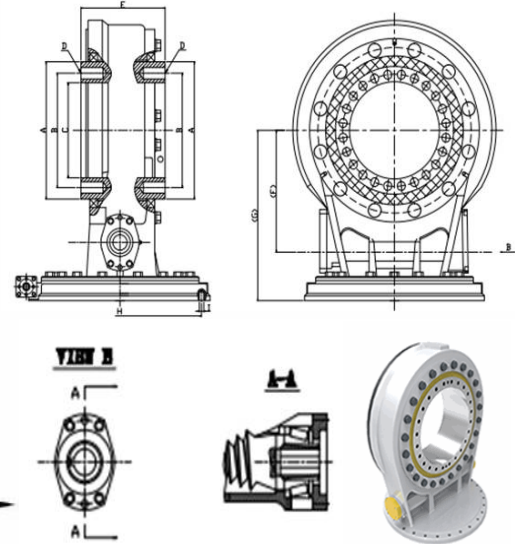
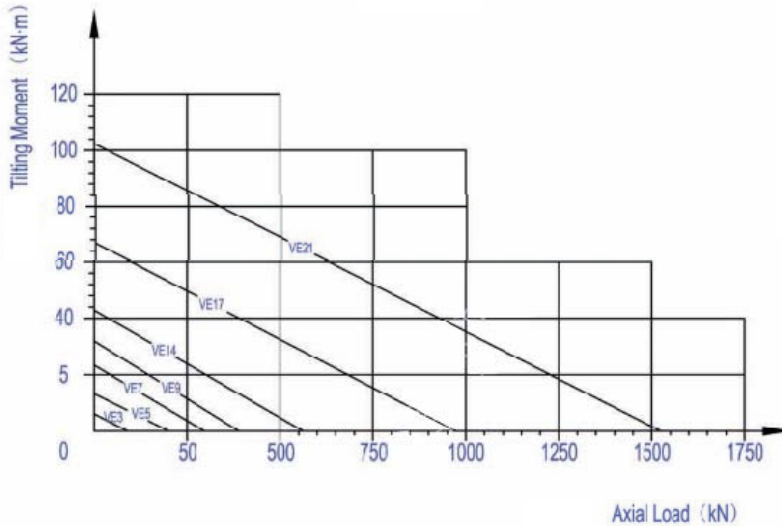

Product description:

	Slewing	Efficiency	Nom.	MAX.	Holding	Tilting	Static	Static	Dynamic	Dynamic	Self-Locking	Torsion	Bending
	Drive		Output	Output	Torgue	Moment	Radial	Axial	Radial	Axial		Stiffness	Stiffness
	Ratio		Torque	Torque		Torque	Rating	Rating	Rating	Rating			
			N.m	N.m	N.m	N.m	KN	KN	KN	KN			Nm/mRad
AVE3	62	43%	599	899	2100	500	8.3	14.7	4.2	4.8	YES	222	106
AVE5	62	43%	849	1274	4340	3508	13.6	34	7	8.2		252	556
AVE7	73	43%	2010	4020	10062	9489	53.3	133.2	27.9	31.9		780	1900
AVE9	61	43%	4480	8960	39083	31500	134.9	337.4	70.9	81		1125	2378
AVE14	85	43%	6497	12994	54455	47460	222	555	116.6	133.2		3400	9224
AVE17	102	43%	9360	18720	65633	94992	390.7	976.8	205.1	234.4		6400	12000
AVE21	125	43%	16010	32020	81000	152380	639.4	1598.5	335.7	383.6		7500	82000

AVE SERIES

Mounting Dimension Sheet

UNIT:mm

TYPE	A	B	C	D	E	F	G	H	I
AVE3	Φ90	Φ70	Φ50	6*M8 DP.16 EQS	93	80	140	Φ100	4*Φ11 EQS
AVE5	Φ90	Φ70	Φ50	6*M8 DP.16 EQS	93	93	140	Φ100	4*Φ11 EQS
AVE7	Φ145	Φ120	Φ25	8*M12 DP.24 EQS	120	132.7	204	135*160	4*Φ17.5
AVE9	Φ180	Φ115	Φ30	8*M16 DP.32 EQS	278	174.1	266	254*190	4*Φ20.5
AVE14	Φ180	Φ130	Φ30	8*M16 DP.32 EQS	280	237.6	305	Φ295	10*Φ18
AVE17	Φ420	Φ290	Φ360	16*M16 DP.32 EQS	220	280.4	364	Φ365.13	16*Φ18
AVE21	Φ470	Φ435	Φ400	24*M20 DP.40 EQS	254	345	598	Φ466.7	26*Φ22



Technical Data



Product name: AWE SERIES

Affiliate classification: Slewing Drive

Structural parameters:

AWE series are turbine vortex rod rotary devices, which are suitable for faster speed equipment, they can maintaining the self-locking at the same time.

AXIAL LOAD & TILTING MOMENT

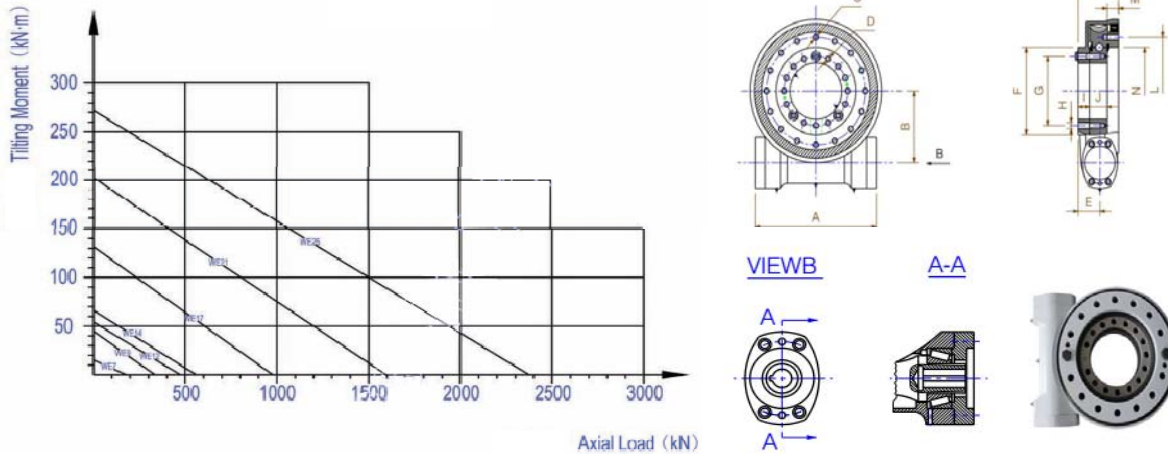

Product description:

	Slewing Drive Ratio	Efficiency	Nom.	MAX.	Holding	Tilting	Static	Static	Dynamic	Dynamic	Self-locking	Torsion	Bending
			Output	Output	Torgue	Moment	Radial	Axial	Radial	Axial		Stiffness	Stiffness
			Torque	Torque		Torque	Rating	Rating	Rating	Rating			
			N.m	N.m	N.m	N.m	KN	KN	KN	KN		Nm/mRad	Nm/mRad
AWE7	73	45%	2010	4020	7034	13556	53.3	133.2	27.9	31.9	YES	780	1900
AWE9	61	45%	4480	8960	39083	45000	135	337.4	70.9	81		1125	2378
AWE12	78	45%	5795	11590	49975	54240	190.3	475.1	99.8	114		2000	4191
AWE14	85	45%	6497	12994	54455	67800	222	555	116.6	133.2		3400	9224
AWE17	102	45%	9360	18720	65633	135600	390.7	976.8	205.1	234.4		6400	12000
AWE21	125	45%	16010	32020	81000	203400	639.4	1598.5	335.7	383.6		7500	82000
AWE25	150	45%	24011	42995	89100	271164	944	2360	472	590		8400	82000

AWE SERIES

Mounting Dimension Sheet

UNIT:mm

TYPE	A	B	C	D	E	F	G	H	I	J	K	L	M	N
AWE7	295	142.5	10*M12 EQS	11*M12 Based on 12 EQS	48.5	Φ195	Φ135	Φ14	16	25	95	Φ205	25	Φ175
AWE9	330	180	16*M16 EQS	15*M16 Based on 16 EQS	57	Φ220	Φ175	Φ18	32	30	108	Φ270	30	Φ222.5
AWE12	370	222.5	18*M16 EQS	19*M16 Based on 20 EQS	57	Φ300	Φ259	Φ18	32	30	108	Φ358	30	Φ310
AWE14	380	237.5	18*M16 EQS	23*M16 Based on 24 EQS	57	Φ325	Φ295	Φ18	32	30	108	Φ390	30	Φ342
AWE17	405	285	20*M16 EQS	20*M16 EQS	55	Φ406	Φ365.1	Φ18	30	32	108	Φ479.4	32	Φ430
AWE21	482.5	350	36*M20 EQS	35*M20 Based on 36 EQS	65	Φ550	Φ466.7	Φ22	30	40	130	Φ584.2	40	Φ540
AWE25	515.5	399	36*M20 EQS	35*M20 Based on 36 EQS	65	Φ650	Φ565	Φ22	30	40	130	Φ675	40	Φ630



Technical Data



Product name: ASPE SERIES

Affiliate classification: Slewing Drive

Structural parameters:

The ASPE series is the meshing form of the external tooth type slewing bearing and the small gear, which is suitable for all kinds of engineering machinery.

AXIAL LOAD & TILTING MOMENT

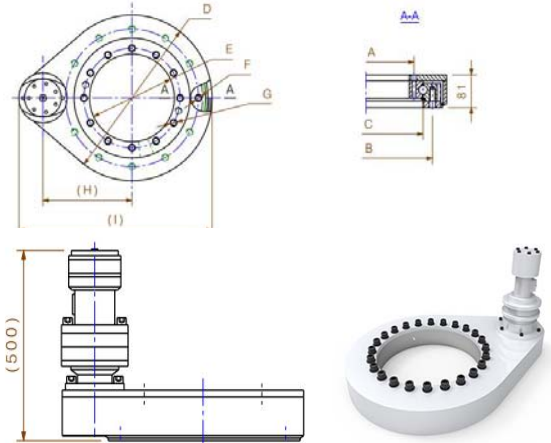
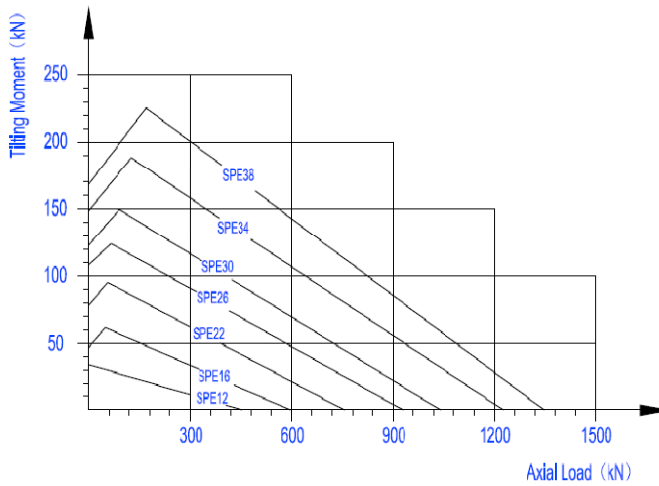

Product description:

	Module	Number	Number	MAX.	Nom.	MAX.	Holding	Tilting	Static	Static	Dynamic	Dynamic	Self-
		of teeth	of teeth	Output	Output	Output	Torgue	Moment	Radial	Axial	Radial	Axial	Locking
		wheel	pinion	Speed	Torque	Torque		Torque	Rating	Rating	Rating	Rating	
				rmp	N.m	N.m	N.m	N.m	KN	KN	KN	KN	
ASPE12	6	67	15	15	6462	8622	8622	32	191	447	140	140	Option
ASPE16	6	83	15	15	8092	10682	10682	51	253	591	155	156	With Brake
ASPE22	8	85	15	15	21590	32670	32670	86	333	778	173	174	
ASPE26	8	98	15	15	25048	37667	37667	115	394	922	184	185	
ASPE30	8	110	15	15	28204	42279	42279	148	456	1066	194	195	
ASPE34	8	122	15	15	32749	47180	47180	180	518	1210	204	205	
ASPE38	8	134	15	15	36342	51888	51888	224	579	1354	212	214	

ASPE SERIES

Mounting Dimension Sheet

UNIT:mm

TYPE	A	B	C	D	E	F	G	H	I
ASPE12	Φ265	Φ360	Φ310	Φ444	Φ236	12*M16 EQS	12*M16 EQS	248.88	575
ASPE16	Φ365	Φ460	Φ410	Φ539	Φ336	16*M16 EQS	16*M16 EQS	296.9	670
ASPE22	Φ495	Φ616	Φ557	Φ720	Φ455	20*M20 EQS	20*M20 EQS	403.86	887
ASPE26	Φ595	Φ716	Φ657	Φ824	Φ555	24*M20 EQS	24*M20 EQS	455.88	991
ASPE30	Φ695	Φ816	Φ757	Φ920	Φ655	24*M20 EQS	24*M20 EQS	503.89	1090
ASPE34	Φ795	Φ916	Φ857	Φ1022	Φ755	28*M20 EQS	28*M20 EQS	554.7	1190
ASPE38	Φ895	Φ1016	Φ957	Φ1120	Φ855	30*M20 EQS	30*M20 EQS	603.65	1290



Technical Data



Product name:ASPI SERIES

Affiliate classification: Slewing Drive

Structural parameters:

The ASPI series is the meshing form of the internal tooth type slewing bearing and the small gear, which is suitable for all kinds of engineering machinery.

AXIAL LOAD & TILTING MOMENT

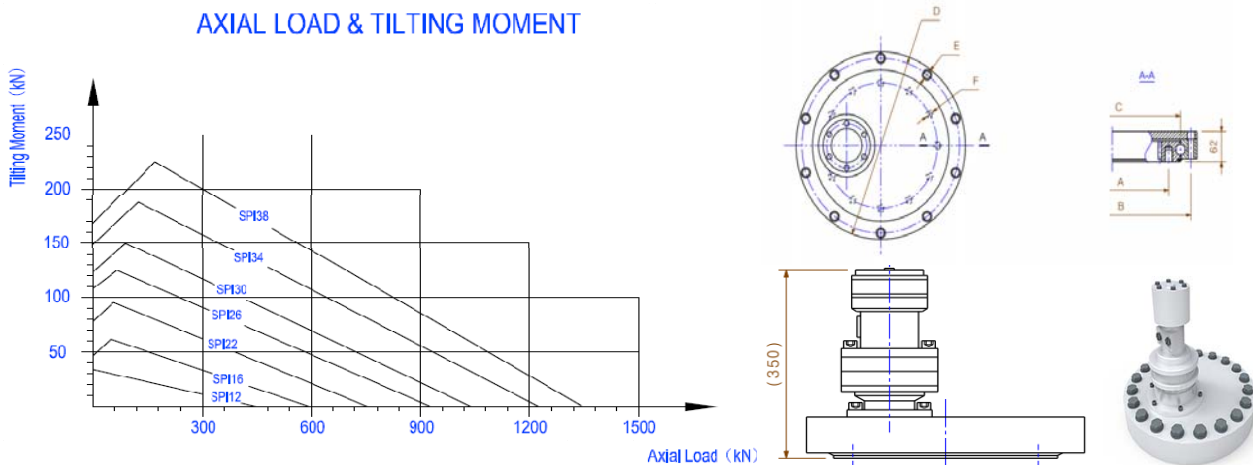

Product description:

	Module	Number	Number	MAX.	Nom	MAX.	Holding	Tilting	Static	Static	Dynamic	Dynamic	Self-
		of teeth	of teeth	Output	.Output	Output	Torgue	Moment	Radial	Axial	Radial	Axial	Locking
		wheel	pinion	Speed	Torque	Torque		Torque	Rating	Rating	Rating	Rating	
				rmp	N.m	N.m	N.m	N.m	KN	KN	KN	KN	
ASPI12	6	37	16	15	6462	8622	8622	32	191	447	140	140	Option
ASPI16	6	54	16	15	8092	10682	10682	51	253	591	155	156	With Brake
ASPI22	8	75	16	15	21590	32670	32670	86	333	778	173	174	
ASPI26	8	92	16	15	25048	37667	37667	115	394	922	184	185	
ASPI30	8	108	16	15	28204	42279	42279	148	456	1066	194	195	
ASPI34	8	125	16	15	32749	47180	47180	180	518	1210	204	205	
ASPI38	8	142	16	15	36342	51888	51888	224	579	1354	212	214	

ASPI SERIES

Mounting Dimension Sheet

UNIT:mm

TYPE	A	B	C	D	E	F
ASPI12	Φ265	Φ360	Φ310	Φ350	12*M16 EQS	12*M16 EQS
ASPI16	Φ365	Φ460	Φ410	Φ450	16*M16 EQS	16*M16 EQS
ASPI22	Φ495	Φ616	Φ557	Φ600	20*M20 EQS	20*M20 EQS
ASPI26	Φ595	Φ716	Φ657	Φ700	24*M20 EQS	24*M20 EQS
ASPI30	Φ695	Φ816	Φ757	Φ800	24*M20 EQS	24*M20 EQS
ASPI34	Φ795	Φ916	Φ857	Φ900	28*M20 EQS	28*M20 EQS
ASPI38	Φ895	Φ1016	Φ957	Φ1000	30*M20 EQS	30*M20 EQS